

Studio 1 spec:

Approx. 45ftx55ft

Power:

1x 63a three-phase

3x 63a single-phase

1x 32a three-phase

3x 32a single phase

8x16a single phase (7x at main power drop, 1x in FoH room)

Access hours: 10am-10pm

Audio:

Allen & Heath dLive S7000

S7000 surface: 36x faders, 2x screens, 8x XLR in, 8x XLR out, 2x AES in, 3x AES out, 2x IO ports

DM48 MixRack: 48x mic/line inputs, 24x line outputs, 3x IO ports.

Dante card that fits in surface/rack 64ch in/out)

80m cat5 multi

8x Turbosound TFM 450s

2x Turbosound THL2 Hilight Series Speakers with linked subs

Mic Box:

2x Shure SM57

1x Shure beta 57a

1x Shure SM58

1x Shure beta 58a

1x Audix OM6

2x Sennheiser e609

2x Audix D2

1x Shure beta 52

3x Shure beta 56

3x Shure SM94

6x BSS AR133 D.I. Box

Mic Stands:

1x Straight Stand

10x Tall Boom Stands

6x Short Boom Stands



Cable Box:

5x long EP6

5x medium EP6

5x short EP6

40x XLR

1x 4-way XLR loom

1x 8-way XLR loom

1x 24-way XLR loom

1x 12-way stage box

1x 16-way stage box

2x 32-amp cable

5x 16-amp cable

5x power drops

1x 4-way 13amp plug board

STUDIO 1 DOWNSTAIRS

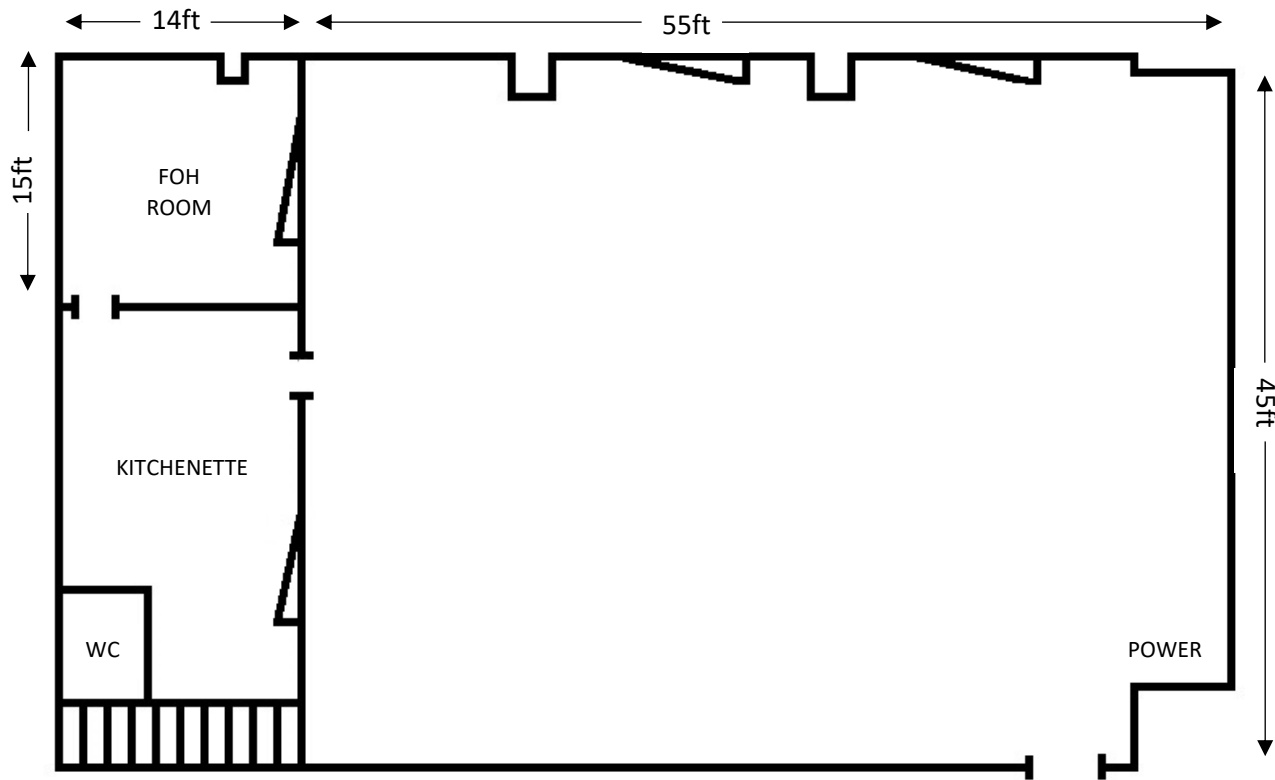

STUDIO 1 UPSTAIRS

